

Date:

Comments:

Project:



Gantom iQ/iQX



Gantom iQ/iQX Accessories



Gantom iQ/iQX

## Product Model

- |       |   |                                      |
|-------|---|--------------------------------------|
| GT31  | - | Gantom iQ - Cool White               |
| GT32  | - | Gantom iQ - Warm White               |
| GC241 | - | Gantom iQX - Cool White (DMX) - RJ45 |
| GC242 | - | Gantom iQX - Warm White (DMX) - RJ45 |

## Description

The Gantom iQ and iQX are the world's smallest gobo projector with adjustable zoom and focus. Using LED technology and special optics, these fixtures can render bright and sharp images from a variety of gobo materials including metal, glass, and even film. The DMX controlled iQX features built-in special effects patterns perfect for adding a dynamic element to any display.

## Features

- Smallest gobo projector with zoom and focus on the market
- Zoom adjustable with front sliding lens: 25-40 degrees
- Focus adjustable with rear sliding lens
- Supports all standard gobo materials including metal, glass, and film
- 5 stage optics render razor sharp images and patterns
- Low voltage and consumes less than 3W

## Applications

- Themed entertainment
- Restaurants
- Special events
- Tradeshow booths
- Museum displays
- Theater and stage accent lighting
- Mobile displays
- Retail spaces

## Optional Components

### Accessories

- |       |   |
|-------|---|
| FA21  | Angled Beam Control Cowling for 30 mm Fixture - Black Anodized Finish |
| FA24  | Beam Control Snoot 30 mm Fixture - Black Anodized Finish              |
| FA30  | Way Cover for the Gantom iQ and Gantom i QX                           |
| FA31  | Gel and Diffuser Retainer for 30 mm Fixture - Black Anodized Finish   |
| PM67  | Ping Swivel Mount w/ Collar for 30mm and 40mm fixtures                |
| TL301 | RJ45 Adapter for Stucchi EVO Track                                    |

### Technical Specifications

#### Physical

Material	Black Anodized Aluminum
IP rating	IP65 when using FA30 not for outdoor install
Weight	195 grams (6.9 oz)

#### Electrical

Voltage	12- 24V DC
Power	0.356a ~ 0.195a @ 4.8W max
Dimming	DMX
Connector	GT31/GT32 - 2.1mm DC Barrel GC241/GC242 - RJ45

#### Thermal

Ambient operating temperature	0-50° C (32-122° F)
Cooling method	Passive

#### Certifications

USA / Canada	UL
Europe	CE, RoHS

#### DMX

Channel footprint	iQX: 3
Addressing	DarkBox Programmer
Lowest dimming	0.05% (DMX ONLY)

#### DMX Mapping

IQX: CH. 1	Intensity (0%-100%)
IQX: CH. 2	Strobe/Effect Speed
IQX: CH. 3	Effect

#### LED color

Cool White	6500K
Warm White	3000K

#### Source

LED model	Cree Xlamp XP-G
-----------	-----------------

#### Warranty

Fixture	2 Years
---------	---------

### Photometrics at Full Power

	Beam Angle	1m Illuminance (3.3ft)	2m Illuminance (6.6ft)	3m Illuminance (9.8ft)
Cool White - Narrowest Beam	25°	510 lx (47.4 fc)	123 lx (11.4 fc)	53 lx (4.9 fc)
Cool White - Widest Beam	40°	368 lx (34.2 fc)	91 lx (8.5 fc)	38 lx (3.5 fc)
Warm White - Narrowest Beam	25°	340 lx (31.6 fc)	82 lx (7.6 fc)	38 lx (3.5 fc)
Warm White - Widest Beam	40°	232 lx (21.6 fc)	63 lx (5.9 fc)	27 lx (2.5 fc)

Distance to Projection Surface	1m (3.3 ft)	2m (6.6 ft)	3m (9.8 ft)
Narrowest Beam Diameter	0.4m (1.3 ft)	0.9m (3.0 ft)	1.3m (4.3 ft)
Widest Beam Diameter	0.6m (2.0 ft)	1.3m (4.3 ft)	2.2m (7.2 ft)

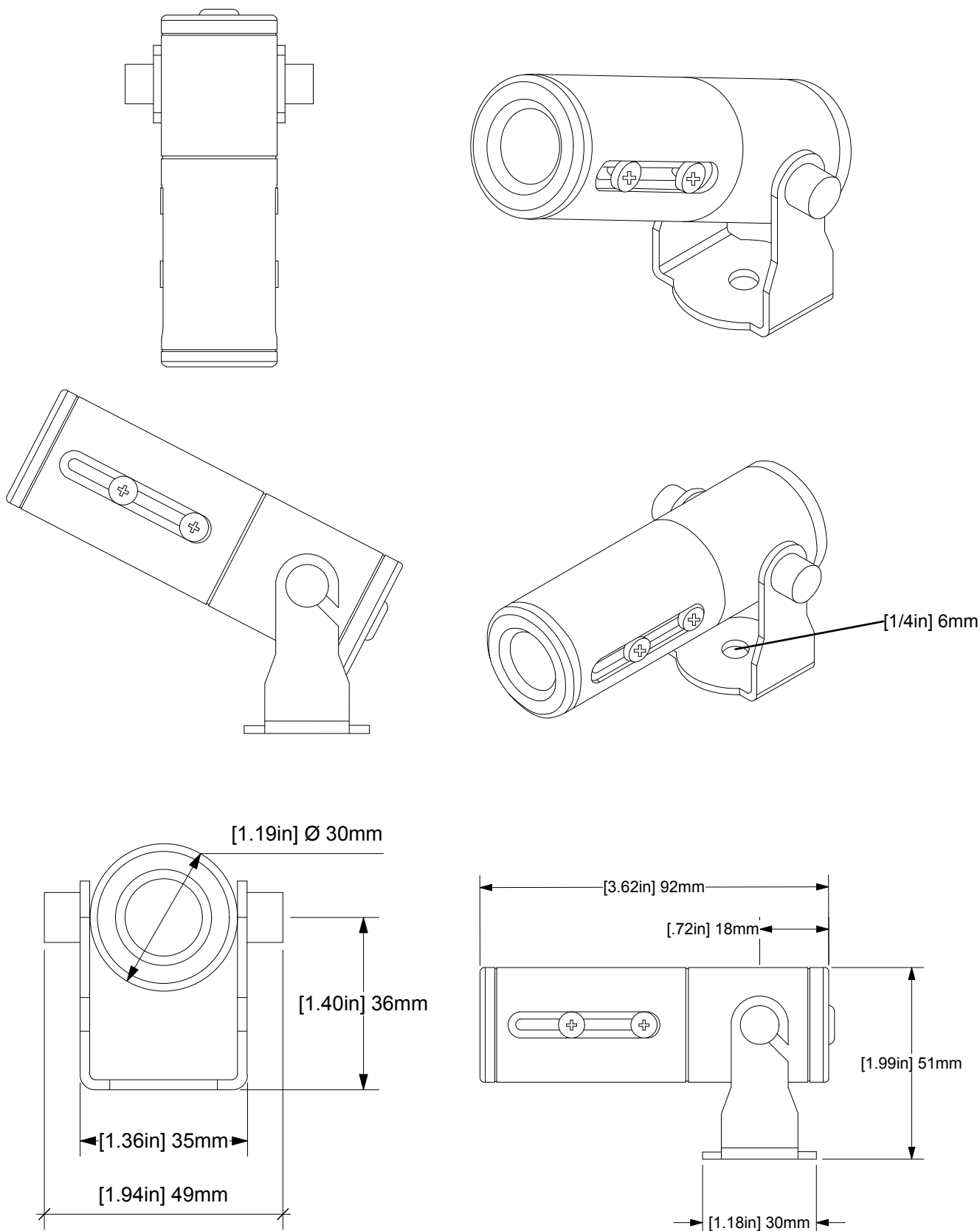

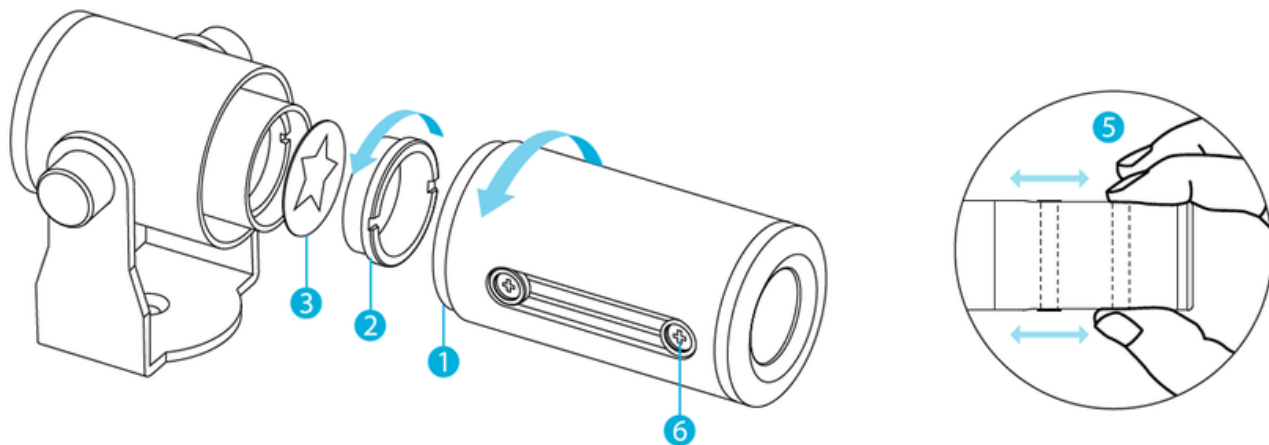

## Gobo installation

1. Unscrew lens assembly
2. Unscrew gobo cap
3. Insert gobo pattern or filter into gobo holder
4. Reassemble
5. Zoom/focus with index finger and thumb pinching both sides of lens assembly (place each finger on opposing lens screw) and slide lens back and forth along adjustment rails. Note: lens will not adjust if only pushing on a single lens screw; both sides of lens must be pushed back and forth together for adjustment.
6. If locking of zoom and focus desired, use screwdriver to tighten lens screw.
7. If outdoor application, tape up zoom/focus adjustment rails to prevent water/dust from entering lens assembly, otherwise optics will distort.

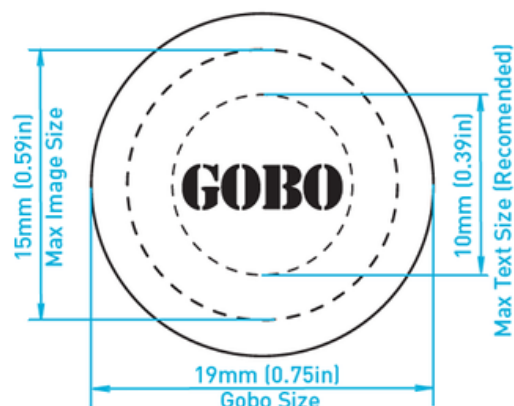

## FAQ

**Q:** What kind of gobos can you use with the Gantom iQ?

**A:** Any pattern that is cut into a 19mm (0.75in) diameter disk. Traditional gobos such as stainless steel or glass will work for permanent installations. For temporary events, inexpensive, full-color gobos can be made from 35mm film slides or self-printed onto transparency paper.

For full-color, film gobos, visit: [www.colorslic.com](http://www.colorslic.com). It is important that you know [www.colorslic.com](http://www.colorslic.com) will print your gobo designs but cannot cut them into the correct circular shape. For this we recommend purchasing a 19mm (0.75in) craft punch online or at a craft store. Please note that film slides will fade over time as the film is a photosensitive material. Although this process renders sharp, full-color images at a low price, these slides are designed for temporary use. Please consider stainless steel or glass for permanent applications.

For stainless steel or glass gobos visit: [www.rosco.com](http://www.rosco.com).

**Q:** Can I print my own patterns?

**A:** Yes! As long as you are able to create well-defined patterns on a 19mm (0.75in) diameter disk that is less than 2mm (0.08in) thick, it will load easily into the Gantom iQ and can render sharp patterns. You can also use a high-resolution inkjet printer to create full-color patterns on transparency paper. However, due to the resolution of typical printers and the amount of magnification with our optics, the projected pattern will not be as sharp as professionally made patterns.

**Q:** How long will the Gantom iQ last?

**A:** Because this is an LED product, the Gantom iQ is rated for over 50,000 hours of lifetime. Stainless steel or glass gobos should last indefinitely, while 35mm slides will fade over time.

**Q:** Can I run this from a battery for portable applications?

**A:** Yes, this product only uses about 3W of power and can be powered from a 9V or 12V battery for several hours depending on battery capacity.